

# ALUMAWOOD

ALUMINIUM SCREENING • KWILA, WESTERN RED CEDAR & ISLAND GREY

INTERPON UNDERCOAT • ITALIAN IMAGE FILM

AUSTRALIA'S BEST QUALITY AT UNBEATABLE PRICES

## SYSTEM ADVANTAGES

Concealed fixing: screws are hidden – clean finish!



Low maintenance – unlike timber screening



Cost effective solution



Hinged & sliding gates also available



Adjustable slat spacing





## ECO FRIENDLY

Slats have commonly been made from harvested timber which must be repeatedly painted. Alumawood slats are made from aluminium – the most abundant metal in the Earth's crust and third most abundant element (after oxygen and silicon). There are no ongoing painting issues with imaged slats.



## FIRE RETARDANT

Aluminium is described as non-combustible. When aluminium is exposed to a prolonged fire environment it will begin to melt (not burn) with a melting point between 600 and 660 degrees celsius. Aluminium slats are an excellent choice where fire risk requires consideration.



## WEATHER & INSECT PROOF

Imaged aluminium is impervious to insects and termites plus the non-porous surface is naturally resistant to fungi, mould and mildew. It is also unaffected by exposure to sunlight and water making it ideal for batten/screening solutions.



## LIGHT WEIGHT

Aluminium weighs approximately one third of a piece of steel that is the same size and shape. Alumawood is made by extruding aluminium which allows for optimisation of shape to maximise strength and reduce weight.



## COLOUR STABILITY

Alumawood features genuine Interpon basecoat with Italian film for a long lasting finish.

Woodgrain effect imaged aluminium has a durable base coat applied followed by a technically advanced film which is transferred onto the base coat under heat & pressure. The transfer cannot rub or peel off. The sophisticated process is called sublimation.



## RUST PROOF

Aluminium does not rust. Alumawood may be enjoyed for the long term with minimal maintenance and no worry of rusting.

Aluminium is produced to chemical composition, mechanical property and dimensional tolerances in AS/NZS 1866:1997.

- AS/NZS ISO 9001:2008 – Quality Management Systems
- AS/NZS ISO 14001:2004 – Environmental Management Systems
- AS/IEC 17025-NATA – NATA Accredited Mechanical Testing Laboratory

now  
available!

**ISLAND GREY**

**ALUMINIUM SLAT SCREENING**

WITH MONUMENT POWDER COAT  
POSTS & ACCESSORIES



Timber imaged aluminium

**65mm x 16.5mm slat  
with centre web**

5800MM LONG

Order Code: **AW-5800-S65-IG**

- Alloy 6063-T6
- 1.2mm wall thickness with centre web
- Ideal match with Trex™ Island Mist board

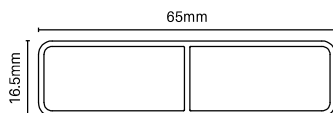

**Finishes**



ISLAND GREY



**65mm x 16.5mm gate  
slat with centre web &  
2x screw flutes**

5800MM LONG

Order Code: **AW-5800-GB65-IG**

- Required for gate assembly

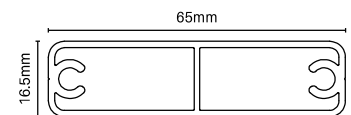

**Finishes**



ISLAND GREY

# SLAT OPTIONS



## 65mm x 16.5mm slat with centre web

5800MM LONG  
Order Code: AW-5800-S65

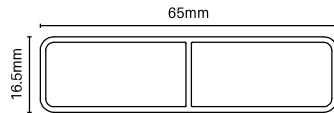

### Finishes



KWILA  
(KWI)



WESTERN  
RED CEDAR  
(WRC)



ISLAND GREY  
(IG)

## TECH SPECS

- PP 157 / AP 157
- Alloy 6063-T6
- 5800mm long
- 1.2mm wall thickness with centre web
- 3.5mm radius corners
- Interpon base coat; Italian image film
- bxx = 9.60 x 10E3 mmE4
- lyy = 83.09 x 10E3 mmE4

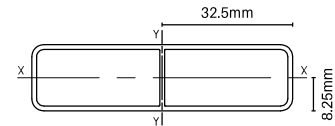

CENTRE WEB ADDS STRENGTH  
& RIGIDITY TO SLAT



## 65mm x 16.5mm gate slat with centre web & 2x screw flutes

5800MM LONG  
Order Code: AW-5800-GB65

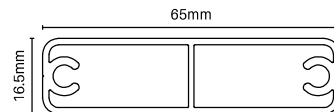

### Finishes



KWILA  
(KWI)



WESTERN  
RED CEDAR  
(WRC)



ISLAND GREY  
(IG)

## TECH SPECS

- PP 158 / AP 158
- Alloy 6063-T6
- 5800mm long
- 1.5mm wall thickness with 1.2mm wall centre web
- 2x screw flutes
- Interpon base coat; Italian image film
- Used in strategic positions for gate assembly
- Non weld assembly using 12 gauge screws into screw flutes (Code: XP-SCREWSGF-10PK)
- bxx = 11.85 x 10E3 mmE4
- lyy = 144.09 x 10E3 mmE4

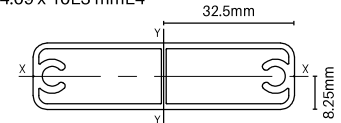

SCREW FLUTES USED IN  
GATE ASSEMBLY



## 90mm x 16mm slat with centre web

5800MM LONG  
Order Code: AWQS-5800-S90-WRC

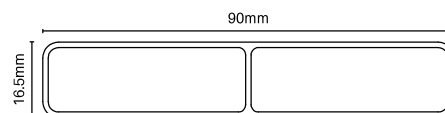

### Finishes



WESTERN RED CEDAR  
(WRC)

## TECH SPECS

- PP 208 / AP 208
- Alloy 6063-T6
- 5800mm long
- 1.2mm wall thickness with centre web
- 3mm radius corners
- Interpon base coat; Italian image film
- bxx = 13.28 x 10E3 mmE4
- lyy = 202.57 x 10E3 mmE4

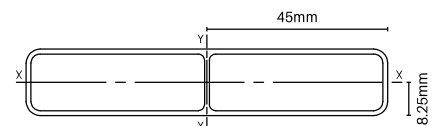

CENTRE WEB ADDS STRENGTH  
& RIGIDITY TO SLAT

# ALUMAWOOD HORIZONTAL SLAT SYSTEM

For Island Grey

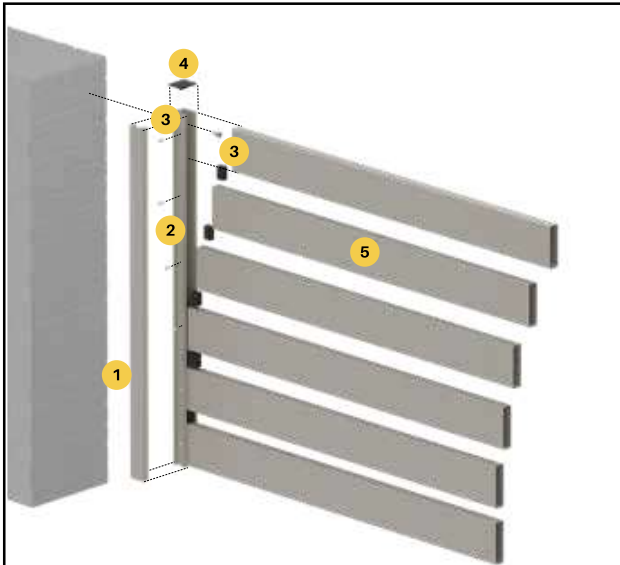

**1 Concealed fixing cover**  
AWQS-5800-CFC  
Refer page 107

**2 Side frame**  
AWQS-5800-SF  
Refer page 107

**3 Spacers & screws**  
QS-KIT  
Refer page 113

**4 Side frame top cap**  
QS-SFC-B  
Refer page 108

**5 65x16.5mm or 90x16mm slat**  
65mm: AW-5800-S65  
90mm: AWQS-5800-S90-WRC\*  
\*WRC finish only  
Refer page 103

**6 F section**  
AWQS-5800-F  
Refer page 107

**7 135 degree adapter**  
AW-5800-135  
Refer page 109

## POSTS & ACCESSORIES —

- 1** 50x50mm post
- 4** Dress rings
- 2** 65x65mm heavy duty post
- 5** Domical covers
- 3** Top caps
- 6** Base plates

For full range of posts & accessories, see pages 111 & 112  
\*\* Monument powder coat finish to complement Island Grey





## ALUMAWOOD SCREENING EXTRUSIONS

The Alumawood system is extremely cost effective. Each slat is screwed off once in position. The system allows for variable slat spacing so any gap is achievable. Once slats are screwed off, a snap on cover hides the fixings to provide a seamless finish.

For horizontal slat screening, generally the side frame is screwed directly to a post or wall without need of another U channel or angle.

In 'void' situations where slats cannot be fed in from top down, an F section is available. The F section can also be used where it is preferred to pre-make complete panels in a factory and simply install onsite.

For raking panels/angles, slats can be cut at an angle and screwed off making Alumawood an ideal solution for difficult installations.

Vertical slat screening is also easily achievable with Alumawood extrusions.

Available in long length supply or custom made to size ready for assembly.

# ALUMAWOOD EXTRUSIONS



## Side frame

5800MM LONG

Order Code: **AWQS-5800-SF**  
**QS-5800-SF-MN**

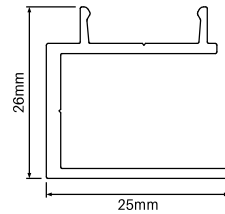

### Finishes



KWILA  
(KWI)



WESTERN  
RED CEDAR  
(WRC)



MONUMENT  
(MN)  
*For Island Grey*

## TECH SPECS

- PP 104 / AP 156
- Alloy 6063-T6 / 5800mm long
- Each slat must be screw fixed to side frame
- For horizontal slat – affix side frame directly to post or wall or use with F-section
- For vertical slat – use as top/bottom frame into which slats are inserted
- Screw fixings are hidden when panel is assembled
- lxx = 9.58 x 10E3 mmE4
- lyy = 8.38 x 10E3 mmE4

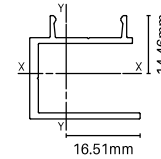

## Concealed fixing cover

5800MM LONG

Order Code: **AWQS-5800-CFC**  
**QS-5800-CFC-MN**

**MATES WITH AWQS-5800-SF**  
**QS-5800-SF-MN**

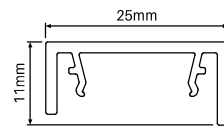

### Finishes



KWILA  
(KWI)



WESTERN  
RED CEDAR  
(WRC)



MONUMENT  
(MN)  
*For Island Grey*

## TECH SPECS

- PP 100 / AP 116
- Alloy 6060-T5 / 5800mm long
- Snap-on cover for Alumawood side frame
- Hides screws used to affix slats to side frame
- Cover not required in vertical slat installs
- lxx = 0.71 x 10E3 mmE4
- lyy = 6.58 x 10E3 mmE4

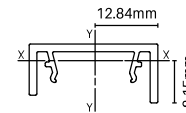

## F section

5800MM LONG

Order Code: **AWQS-5800-F**  
**QS-5800-F-MN**

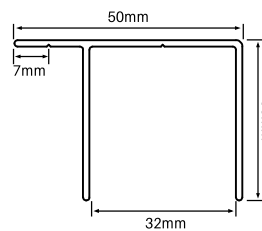

### Finishes



KWILA  
(KWI)



WESTERN  
RED CEDAR  
(WRC)



MONUMENT  
(MN)  
*For Island Grey*

## TECH SPECS

- PP 170 / AP 234
- Alloy 6063-T6
- 5800mm long
- Fix off to wall or post through 15mm offset leg
- For horizontal slat – use in a void situation or if panels pre-assembled in factory for installation onsite
- For vertical slat – use as vertical side frames into which horizontal top/bottom rails are inserted
- 1.4mm wall thickness
- lxx = 20.76 x 10E3 mmE4
- lyy = 42.29 x 10E3 mmE4

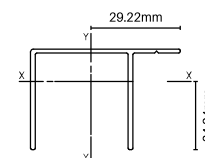



# ALUMAWOOD EXTRUSIONS



## Heavy duty U channel top/bottom frame

5000MM LONG

Order Code: **AWQS-5000-HORIZ**  
**QS-5000-HORIZ-MN**

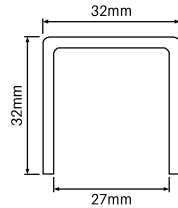

**FOR VERTICAL  
SLAT**

### Finishes



KWILA  
(KWI)



WESTERN  
RED CEDAR  
(WRC)



MONUMENT  
(MN)  
*For Island Grey*

## TECH SPECS

- PP 184 / AP 184
- Alloy 6060-T5
- 5000mm long
- For horizontal slat - not required
- For vertical slat - use as top/bottom U channel frame into which frames inserted (refer code AWQS-5800-SF)
- 2.5mm wall thickness
- bxx = 23.97 x 10E3 mmE4
- lyy = 38.92 x 10E3 mmE4

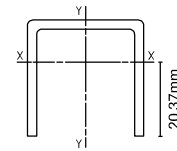

## Centre support rail

5800MM LONG

Order Code: **AW-5800-CSR**  
**XP-5800-CSR-MN**

### OPTIONAL EXTRA

Commonly used for screens 2000mm or wider to provide strength & rigidity to panel

Snap-on cover hides fixings – provides slimline sturdy support rail with no visible fixings

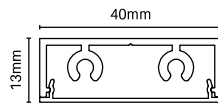

### Finishes



KWILA  
(KWI)



WESTERN  
RED CEDAR  
(WRC)



MONUMENT  
(MN)  
*For Island Grey*

## TECH SPECS

- PP 126 / AP 188
- Alloy 6063-T5
- 5800mm long
- Screw fix off to each slat to provide support/rigidity
- For horizontal slat – support rail installed vertically to brace horizontal slats
- For vertical slat – support rail installed horizontally to brace vertical slats
- Includes 2x screw flutes for cap insertion
- bxx = 1.73 x 10E3 mmE4
- lyy = 26.34 x 10E3 mmE4

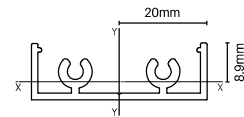

**MATES WITH AW-5800-CSR**

## Centre support rail cap

40mm x 13mm

3MM THICK

Order Code: **XP-CSRC-B**

- Black nylon cap
- Simply press into screw flutes in centre support rail
- Easy and fast fitting of cap



**MATES WITH AW-5800-CSR**  
**XP-5800-CSR**

## Centre support rail top/bottom plate

Order Code: **AW-BTP-TR**  
**XP-BTP-MN**

- Optional extra to install as part of centre support rail
- Aluminium with countersunk hole machining
- Terrain powder coat finish matches well with Kwila & WRC finishes
- Monument powder coat matches with Island Grey
- 2x CSK screws included for fixing to CSR
- Use to brace top and/or bottom of centre support rail to structure above or below if desired
- Bracing centre support rail provides extra rigidity to panels – recommended for wide screens



MONUMENT  
(MN)  
*For Island Grey*



**MATES WITH**  
**AWQS-5800-SF**  
**+**  
**AWQS-5800-CFC**

## Side frame top cap

30mm x 26mm

3MM THICK

Order Code: **QS-SFC-B**

- Black nylon cap
- Simply press into side frame
- Easy and fast fitting of cap



Screw top/bottom plate to centre support rail



Screw through central hole to substrate at top or bottom

# ALUMAWOOD 135 ANGLE ADAPTER

## 135 degree adapter

5800MM LONG

Order Code: AW-5800-135

XP-6000-135-MN



## TECH SPECS

- PP 109 / AP 163
- Alloy 6060 - T5
- Simple 2 step process:
  - (1) Adapter simply fixes to post/wall.
  - (2) Quickscreen side frame then attached to adapter into which slats insert
- Ideal for when screens to run at 135 degree angle from post or wall
- lxx = 5.76 x 10E3 mmE4
- lyy = 25.92 x 10E3 mmE4

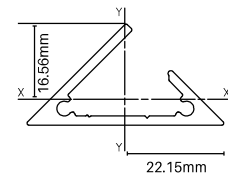
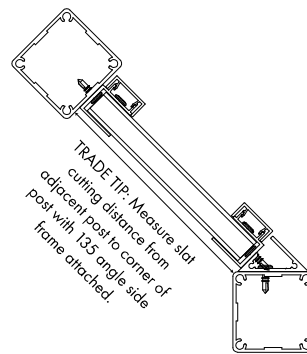
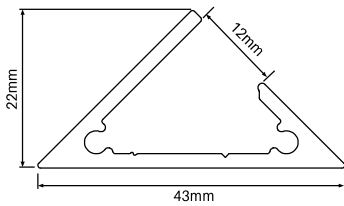

## Finishes



KWILA (KW)



WESTERN RED CEDAR (WRC)



MONUMENT (MN)  
For Island Grey

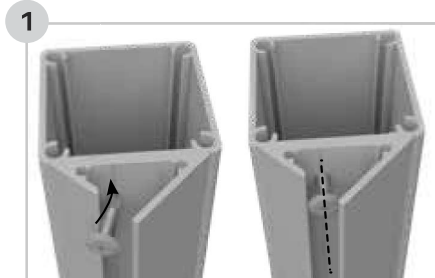

Place 135 adapter against post/wall. Insert screw into void opening. Screw fix adapter using V groove as a guide to fixing location.  
TIP: pilot hole drill before screw fixing; max screw head size is 10mm.

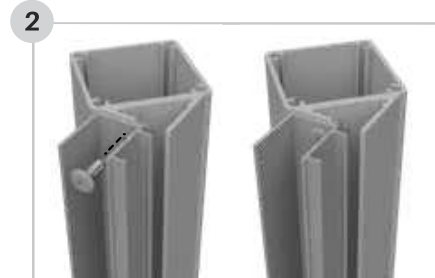

Screw fix Quickscreen Side Frame with screw positioned slightly offset from centre (closer to the snap on cover side) but ensure screw sufficiently engages with short leg of 135 angle adapter.

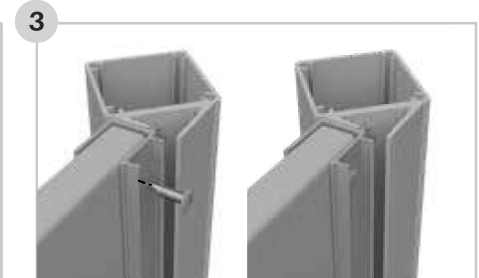

Insert slats into Quickscreen side frame and fix off slats.

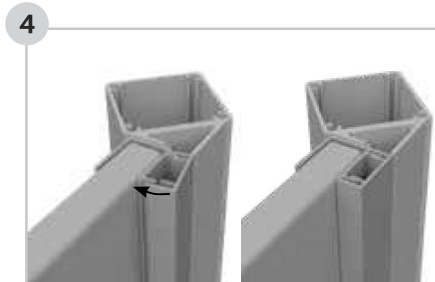

Snap on concealed fixing cover. Lever into place with short leg going on first then levering on long leg to snap into position.

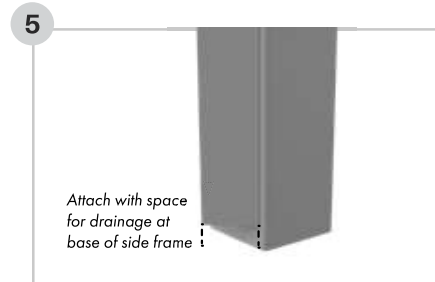

135 angle adapter should be cut so that it is elevated from floor and at the same length as Quickscreen Side Frame.

# NOW AVAILABLE HORIZONTAL SLAT BALUSTRADE



Four stylish infill designs  
to choose from



Save time & money without  
compromising quality or style



Non-weld assembly  
and easy installation



Engineering certification  
approved for balustrading

## Why choose horizontal slat balustrade?

AIRE Horizontal Slat Balustrade is a complete non-weld system which perfectly typifies the saying 'simplicity is the ultimate form of sophistication'. With sleek lines and innovative design consideration ensuring screw fixings are hidden, the system is easy to install and yet provides for a stunning finish.

The system is stocked in 3 popular powder coat finishes – satin black, monument matt and pearl white glass. It is also available in mill finish allowing customisation of powder coat colour. Pre-powder coated material can be cut to required lengths and assembled onsite. The installation process is simple and effective – side frames are affixed to the sturdy aluminium posts and horizontal slats are screw fixed either side with a fixing cover hiding screws.

The system has been extensively load tested by accredited NATA testing facilities. Importantly, engineering compliance certification is available.



01

### Horizontal Slat Balustrade

Horizontal slat balustrade with 9mm  
spacing with welded base plated posts

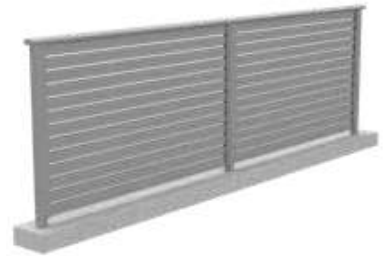

02

### Horizontal Slat Balustrade

Horizontal slat balustrade with 9mm  
spacing with core drill posts

# POSTS & ACCESSORIES

## 50x50mm full post

2400MM, 5800MM or 6000MM LONG  
Order Code: **AW-2400/5800-FP**  
**XP-2400/6000-FP-MN**

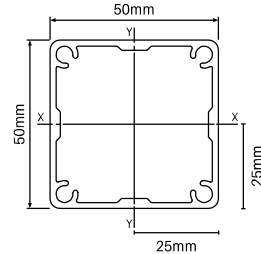

### Finishes



## TECH SPECS

- Alloy 6063 – T6
- 1.8mm wall thickness with 3mm ribs
- Screw flutes to screw on base plate if required
- Press-in aluminium powder coated top plate included with 2400mm posts
- $b_x = 170.44 \times 10E3 \text{ mmE4}$
- $l_{yy} = 170.44 \times 10E3 \text{ mmE4}$

4x screw flutes in post allow tight fit of press in flat aluminium top plate.

Optional base plate can be attached using screw flutes for base plated post installations.



## 50x50mm post flat top plate

POWDER COATED ALUMINIUM

Order Code: **AW-TP-TR / XP-TP-MN**

- Alloy ADC12 aluminium plate
- Powder coated to complement image finish
- Press into post screw flutes for secure fixing
- Suits 50 x 50mm post
- 2400mm posts come with free top plate included – only purchase if extra top plates are required
- Top plates required for 5800mm/ 6000mm posts – sold separately

### Powder coat colour



## 50x50mm post base plate set

POWDER COATED ALUMINIUM

Order Code: **AW-BP-SET-TR**  
**XP-BP-SET-MN**

- Simply screw base plate onto core drill post
- 4x 12G x 50mm long CSK screws included in set

### Powder coat colour

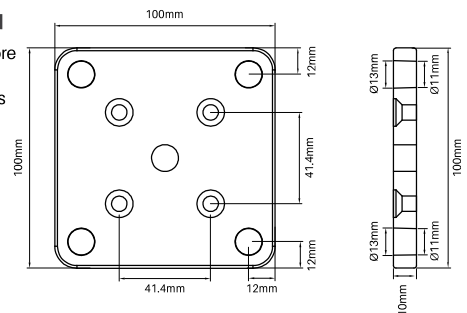

## 50x50mm post dress ring

POWDER COATED ALUMINIUM

Order Code: **AW-DR-TR / XP-DR-MN**

- Suits 50x50mm core drill posts
- Terrain powder coat suits both Kwila & WRC image finishes
- 100mm x 100mm outer – 52mm x 52mm inner

### Powder coat colour



Discreet screws fix two parts of cover together

### Powder coat colour



## Two part domical cover

POWDER COATED ALUMINIUM

Order Code: **AW-DC-2P-TR**  
**XP-DC-2P-MN**

- Suits 50x50mm post with screw fixed base plate
- Terrain powder coat matches well with Kwila & WRC image finish
- 106x106mm outer – 52x52mm inner – Alloy ADC12
- 29.5mm high
- Cover can be fitted to posts after fence is installed with innovative 2 piece design

# POSTS & ACCESSORIES

## 65x65mm heavy duty post

2400MM, 5800MM or 6000MM LONG  
Order Code: **AW-2400/5800-65HD**  
**XP-2400/6000-65HD-MN**

## TECH SPECS

- 65x65mm larger profile, heavy duty post
- Alloy 6063 - T6
- 3mm wall thickness
- Screw flutes to screw on base plate if required
- Aluminium powder coated press-in top plate included with 2400mm posts
- bxx = 464.62 x 10E3 mmE4
- lyy = 464.62 x 10E3 mmE4

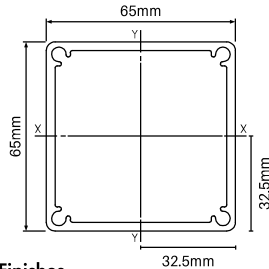

### Finishes



4x screw flutes in post allow tight fit of press in flat aluminium top plate.

Optional base plate can be attached using screw flutes for base plated post installations.



## 65x65mm post flat top plate

POWDER COATED ALUMINIUM

Order Code: **AW-65TP-TR / XP-65TP-MN**

- Alloy ADC12 aluminium plate
- Coated to complement image finish
- Press into post screw flutes for secure fixing
- 2400mm posts come with free top plate included - only purchase if extra top plates are required
- Top plates required for 5800mm/ 6000mm posts - sold separately

### Powder coat colour



## 65x65mm post base plate set

POWDER COATED ALUMINIUM

Order Code: **AW-65BP-SET-TR / XP-65BP-SET-MN**

- Simply screw base plate onto core drill post
- 4x 12G x 50mm long CSK screws included in set

### Powder coat colour

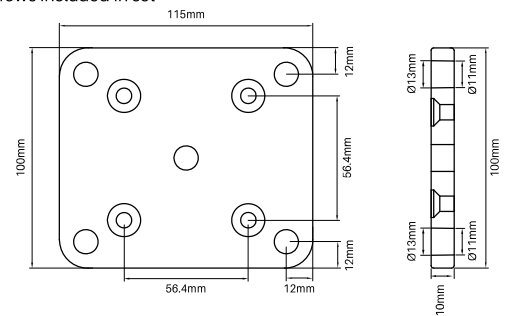

## 65x65mm post dress ring

POWDER COATED ALUMINIUM

Order Code: **AW-65DR-TR / XP-65DR-MN**

- Suits 65x65mm heavy duty post
- Terrain powder coat suits both Kwila & WRC image finishes
- 115mm x 115mm outer - 67mm x 67mm inner

### Powder coat colour



## 65x65mm two part domical cover

POWDER COATED ALUMINIUM

Order Code: **AW-65DC-2P-TR**  
**XP-65DC-2P-MN**

- Suits 65x65mm post with screw fixed base plate
- 122x106mm outer - 67x67mm inner - Alloy ADC12
- 30mm high
- Cover can be fitted to posts after fence is installed

### Powder coat colour



# ACCESSORIES



## Timber fixing kit

4 PACK – SS316  
Order Code: S-110LAG-4PK

- M10 x 110mm timber lag screws x4 with nuts and washers
- Suits fixing holes in both the 50x50mm and 65x65mm base plate sets



## Concrete fixing kit

4 PACK – SS316  
Order Code: S-120ROD-4PK

- M10 x 120mm concrete threaded rods x4 with nuts and washers
- Suits fixing holes in both the 50x50mm and 65x65mm base plate sets



## Screw & spacer kit

SCREWS & SPACER BLOCKS

Order Code: QS-KIT

- 50 screws: 10G x 18mm long
- 10x spacer blocks
- Spacers enable 9mm, 15mm or 20mm spacing between slats
- Use screws to fix off slats
- Remove spacers once slats are screw fixed off



## Louvre brackets

1x LEFT & 1x RIGHT

Terrain

Order Code: AW-LB-TR / QS-LB-MN

- 1x left and 1x right bracket per pack
- Terrain powder matches well with Kwila & WRC image finishes
- Monument powder coat matches well with Island Grey
- Die cast aluminium
- Suits 65x16.5mm slat - Press brackets onto end of slat then insert bracket into side frame
- Space brackets at nil, 5, 9, 20mm or any spacing desired
- Cost effective and fast way to achieve a fixed louvre finish



MONUMENT (MN)  
For Island Grey

40° FINAL SLAT ANGLE

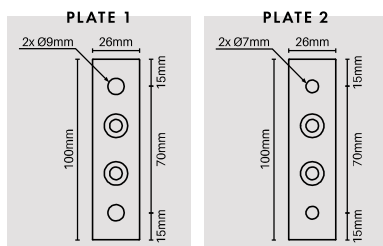
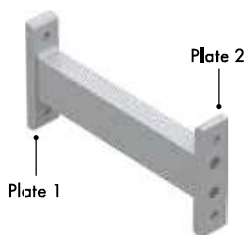
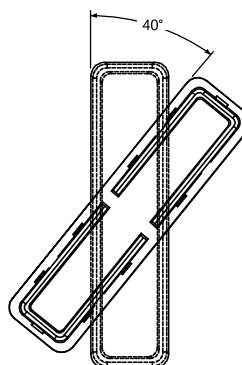

## Side frame mounting arm

200MM or 400MM WIDE

Black / Monument / Woodland Grey  
Silver / Surfmist / Mill finish

Order Code: XP-ARMSF (200mm wide)

XP-ARMSF-400-M (400mm wide – Mill finish)

- Use for mounting screens offset from a vertical surface
- 2x welded fixing plates – 100mm L x 26mm W x 10mm D
- 2x Ø9mm fixing holes (plate 1) & 2x 7mm fixing holes (plate 2)

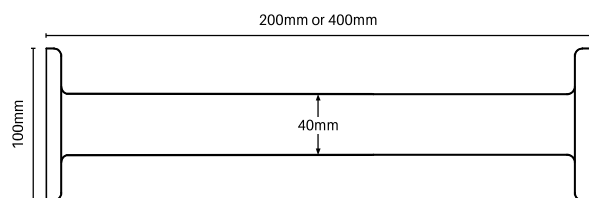

## 100mm support foot

HEIGHT ADJUSTABLE  
SS316 / POLISH FINISH

Order Code: XP-FOOT-ADJ

- Height adjustable support foot for wider or larger screens
- Screw fix to midpoint of underside of bottom rail U channel
- Easily height adjustable (from 25mm up to 100mm) – stainless steel stem can be cut down and bottom flange reattached with grub screw
- Stylish high polish marine grade SS316 finish

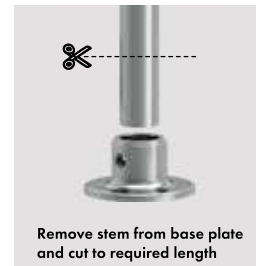
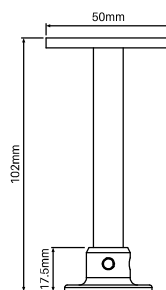

Remove stem from base plate and cut to required length

# ACCESSORIES

## 65MM SLAT CAPS

Suits 65x16.5mm slats  
Order Code: **AW-EC65-TR-4PK**  
**XP-EC65-MN-4PK**



**Powder coat colour**



TERRAIN



MONUMENT (MN)  
For Island Grey

### TECH SPECS

- Alloy ADC12 aluminium flat end cap
- Suits GO's 65x16.5mm slat
- Terrain powder coat finish suits Kwila & WRC slats
- Monument powder coat finish matches well with Island Grey slats
- Press into end of slat
- Innovative design feature with polymer inserts ensures tight press in fit (inserts supplied with every cap)
- Internally slotted so end cap can be used with webbed or non-webbed slats

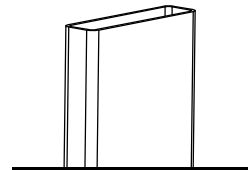
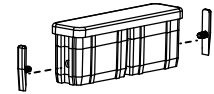

## 90MM SLAT CAPS

Suits 90x16mm WRC slats only  
Order Code: **AW-EC90-TR-4PK**



**Powder coat colour**



TERRAIN

### TECH SPECS

- Alloy ADC12 aluminium flat end cap
- Suits GO's 90x16mm slat
- Terrain powder coat finish suits WRC slats
- Press into end of slat
- Innovative design feature with polymer inserts ensures tight press in fit (inserts supplied with every cap)
- Internally slotted so end cap can be used with webbed or non-webbed slats
- Sold as a 4 pack

### DESIGN INNOVATION

Tapered polymer insert can be installed one or both sides of cap.  
Use inserts if cap not a tight fit in slat.



### Rapid set concrete

20KG BAG  
Order Code: **GROUT-RSC**

- Specially formulated to harden rapidly
- Not available Perth depot - Use 20kg Kwik Set concrete (Code: GROUT-KWIKSET)



Kwikset concrete  
Perth only



### Concrete mix

20KG BAG  
Order Code: **GROUT-CONCRETE**

- Quality blend of GP cement, aggregate & sand - just add water
- Ideal for high strength concreting of posts



### Sika HES grout

20KG BAG  
Order Code: **GROUT-SIKA**

- Non shrink structural grout
- Ready mixed, high quality grout
- Sets with high early strength



### Bostik HES grout

20KG BAG  
Order Code: **GROUT-BOS**

- Non shrink structural grout
- High performance, high early strength



# 65mm slat spacing table

## QUICKSCREEN HORIZONTAL SLAT SYSTEM

### Slat Qty

Total number of slats required for height shown in corresponding rows

### Slat spacing

Height of gap between each slat

### Height

The Alumawood side frames allow for variable gap spacing as each slat is fixed off at desired position. Any gap is achievable. Shown are specifications for the popular spacings of nil, 5mm, 9mm & 20mm spacing.

The formula to calculate variable gap screen height is:  
 $((65\text{mm (slat height)} + \text{desired gap}) \times \text{number of slats}) - \text{desired gap} + 3\text{mm}$   
 (for top cap).

For example, a 30mm desired gap with 14 slats:  $(65 + 30) \times 14 - 30 + 3 = 1303\text{mm}$  high

Slat Qty	Slat spacing	Height	Slat Qty	Slat spacing	Height
5	Nil	328mm	23	Nil	1498mm
	5mm	348mm		5mm	1608mm
	9mm	364mm		9mm	1696mm
	20mm	408mm		20mm	1938mm
6	Nil	393mm	24	Nil	1563mm
	5mm	418mm		5mm	1678mm
	9mm	438mm		9mm	1770mm
	20mm	493mm		20mm	2023mm
7	Nil	458mm	25	Nil	1628mm
	5mm	488mm		5mm	1748mm
	9mm	512mm		9mm	1844mm
	20mm	578mm		20mm	2108mm
8	Nil	523mm	26	Nil	1693mm
	5mm	558mm		5mm	1818mm
	9mm	586mm		9mm	1918mm
	20mm	663mm		20mm	2193mm
9	Nil	588mm	27	Nil	1758mm
	5mm	628mm		5mm	1888mm
	9mm	660mm		9mm	1992mm
	20mm	748mm		20mm	2278mm
10	Nil	653mm	28	Nil	1823mm
	5mm	698mm		5mm	1958mm
	9mm	734mm		9mm	2066mm
	20mm	833mm		20mm	2363mm
11	Nil	718mm	29	Nil	1888mm
	5mm	768mm		5mm	2028mm
	9mm	808mm		9mm	2140mm
	20mm	918mm		20mm	2448mm
12	Nil	783mm	30	Nil	1953mm
	5mm	838mm		5mm	2098mm
	9mm	882mm		9mm	2214mm
	20mm	1003mm		20mm	2533mm
13	Nil	848mm	31	Nil	2018mm
	5mm	908mm		5mm	2168mm
	9mm	956mm		9mm	2288mm
	20mm	1088mm		20mm	2618mm
14	Nil	913mm	32	Nil	2083mm
	5mm	978mm		5mm	2238mm
	9mm	1030mm		9mm	2362mm
	20mm	1173mm		20mm	2703mm
15	Nil	978mm	33	Nil	2148mm
	5mm	1048mm		5mm	2308mm
	9mm	1104mm		9mm	2436mm
	20mm	1258mm		20mm	2788mm
16	Nil	1043mm	34	Nil	2213mm
	5mm	1118mm		5mm	2378mm
	9mm	1178mm		9mm	2510mm
	20mm	1343mm		20mm	2873mm
17	Nil	1108mm	35	Nil	2278mm
	5mm	1188mm		5mm	2448mm
	9mm	1252mm		9mm	2584mm
	20mm	1428mm		20mm	2958mm
18	Nil	1173mm	36	Nil	2343mm
	5mm	1258mm		5mm	2518mm
	9mm	1326mm		9mm	2658mm
	20mm	1513mm		20mm	3043mm
19	Nil	1238mm	37	Nil	2408mm
	5mm	1328mm		5mm	2588mm
	9mm	1400mm		9mm	2732mm
	20mm	1598mm		20mm	3128mm
20	Nil	1303mm	38	Nil	2473mm
	5mm	1398mm		5mm	2658mm
	9mm	1474mm		9mm	2806mm
	20mm	1683mm		20mm	3213mm
21	Nil	1368mm	39	Nil	2538mm
	5mm	1468mm		5mm	2728mm
	9mm	1548mm		9mm	2880mm
	20mm	1768mm		20mm	3298mm
22	Nil	1433mm	40	Nil	2603mm
	5mm	1538mm		5mm	2798mm
	9mm	1622mm		9mm	2954mm
	20mm	1853mm		20mm	3383mm





# 90mm slat spacing table

## QUICKSCREEN HORIZONTAL SLAT SYSTEM

### Slat Qty

Total number of slats required for height shown in corresponding rows

### Slat spacing

Height of gap between each slat

### Height

The Alumawood side frames allow for variable gap spacing as each slat is fixed off at desired position. Any gap is achievable. Shown are specifications for the popular spacings of nil, 5mm, 9mm & 20mm spacing.

The formula to calculate variable gap screen height is:  
 $((90\text{mm (slat height)} + \text{desired gap}) \times \text{number of slats}) - \text{desired gap} + 3\text{mm}$   
 (for top cap).

For example, a 30mm desired gap with 14 slats:  $(90 + 30) \times 14 - 30 + 3 = 1653\text{mm}$  high

Slat Qty	Slat spacing	Height
5	Nil	453
	5mm	473
	9mm	489
	20mm	533
6	Nil	543
	5mm	568
	9mm	588
7	20mm	643
	Nil	633
	5mm	663
8	9mm	687
	20mm	753
	Nil	723
9	5mm	758
	9mm	786
	20mm	863
10	Nil	813
	5mm	853
	9mm	885
	20mm	973
11	Nil	903
	5mm	948
	9mm	984
	20mm	1083
12	Nil	993
	5mm	1043
	9mm	1083
	20mm	1193
13	Nil	1083
	5mm	1138
	9mm	1182
	20mm	1303
14	Nil	1173
	5mm	1233
	9mm	1281
	20mm	1413
15	Nil	1263
	5mm	1328
	9mm	1380
	20mm	1523
16	Nil	1353
	5mm	1423
	9mm	1479
	20mm	1633
17	Nil	1443
	5mm	1518
	9mm	1578
	20mm	1743
18	Nil	1533
	5mm	1613
	9mm	1677
	20mm	1853
19	Nil	1623
	5mm	1708
	9mm	1776
	20mm	1963
20	Nil	1713
	5mm	1803
	9mm	1875
	20mm	2073
21	Nil	1803
	5mm	1898
	9mm	1974
	20mm	2183
22	Nil	1893
	5mm	1993
	9mm	2073
	20mm	2293
23	Nil	1983
	5mm	2088
	9mm	2172
	20mm	2403

Slat Qty	Slat spacing	Height
23	Nil	2073
	5mm	2183
	9mm	2271
	20mm	2513
24	Nil	2163
	5mm	2278
	9mm	2370
	20mm	2623
25	Nil	2253
	5mm	2373
	9mm	2469
	20mm	2733
26	Nil	2343
	5mm	2468
	9mm	2568
	20mm	2843
27	Nil	2433
	5mm	2563
	9mm	2667
	20mm	2953
28	Nil	2523
	5mm	2658
	9mm	2766
	20mm	3063
29	Nil	2613
	5mm	2753
	9mm	2865
	20mm	3173
30	Nil	2703
	5mm	2848
	9mm	2964
	20mm	3283
31	Nil	2793
	5mm	2943
	9mm	3063
	20mm	3393
32	Nil	2883
	5mm	3038
	9mm	3162
	20mm	3503
33	Nil	2973
	5mm	3133
	9mm	3261
	20mm	3613
34	Nil	3063
	5mm	3228
	9mm	3360
	20mm	3723
35	Nil	3153
	5mm	3323
	9mm	3459
	20mm	3833
36	Nil	3243
	5mm	3418
	9mm	3558
	20mm	3943
37	Nil	3333
	5mm	3513
	9mm	3657
	20mm	4053
38	Nil	3423
	5mm	3608
	9mm	3756
	20mm	4163
39	Nil	3513
	5mm	3703
	9mm	3855
	20mm	4273
40	Nil	3603
	5mm	3798
	9mm	3954
	20mm	4383

# VERTICAL SLAT SYSTEM

The Alumawood System allows 65x16.5mm or 90x16.5mm slats to be installed using a cost effective top/bottom rail system. Each slat requires screwing off at top and bottom. Screws are hidden by a heavy duty "U" section at top and bottom. An "F" section is installed vertically on both sides which allows easy installation between posts or pillars. A complete system is available – panels, pedestrian gates and sliding gates.

**Ideal for installations between pillars and existing posts!**

## ASSEMBLE ON-SITE OR IN YOUR WORKSHOP –

Panels fit into F section on both sides for easy installation. Problems with out of square pillars or posts can be easily overcome with F section fitting.

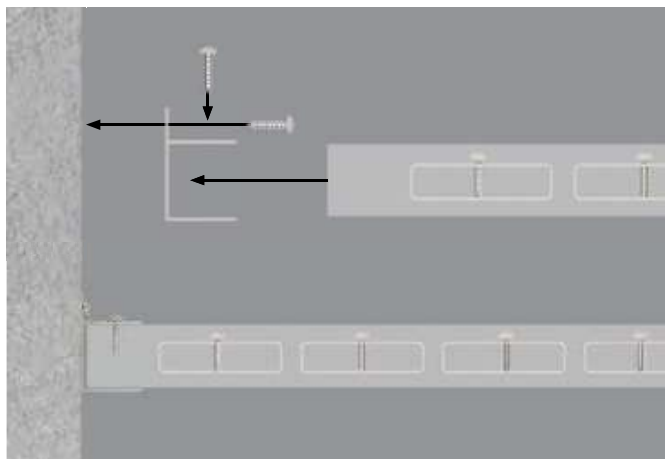

For  
Island Grey

- F section**  
AWQS-5800-F  
Refer page 107



- U channel top/bottom channel**  
AWQS-5000-HORIZ  
Refer page 108



- Top/bottom frame**  
AWQS-5800-SF  
Refer page 107



- 65x16.5mm or 90x16mm slat**  
65mm: AW-5800-S65  
90mm: AWQS-5800-S90-WRC\*  
\*WRC finish only  
Refer page 103

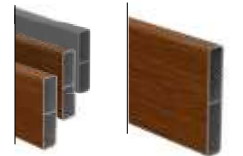

## POSTS & ACCESSORIES –

- |                                  |                         |
|----------------------------------|-------------------------|
| <b>1</b> 50x50mm post            | <b>4</b> Dress rings    |
| <b>2</b> 65x65mm heavy duty post | <b>5</b> Domical covers |
| <b>3</b> Top caps                | <b>6</b> Base plates    |

For full range of posts & accessories, see pages 111 & 112  
\*\*Monument powder coat finish to complement Island Grey



# innovative, non-weld Pedestrian gates

AVAILABLE IN 2 CONVENIENT SUPPLY OPTIONS

1

## Long length supply

Buy long length extrusions then cut to size and assemble on-site or at your premises

2

## Cut to size service

Simply provide gate size required – we will cut to size and flat pack for easy assembly



# GATE EXTRUSIONS

## Slat Options

Refer page 105



**PATENTED FRICTION FIT SYSTEM**

### 9MM SPACING Slotted gate side frame

4200MM LONG

Order Code: **AWXP-4200-GSF09**  
**XP-4200-GSF09-MN**

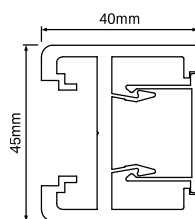

### TECH SPECS

- PP 170
- Alloy 6063-T5 / 4200mm long
- 3mm wall thickness with 3.8mm centre crossmember
- Slotted insert to suit 65x16.5mm slat with 9mm spacing
- Patented frame for friction insertion of slats
- Crossmember machined with drill holes along entire length to suit screw fixing of strategically placed 'gate slats' featuring screw flutes
- lxx = 6.294 x 10E3 mmE4
- lyy = 152.403 x 10E3 mmE4

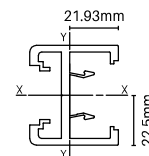

### Finishes



KWILA  
(KWI)



WESTERN  
RED CEDAR  
(WRC)



MONUMENT  
(MN)  
*For Island Grey*



**PATENTED FRICTION FIT SYSTEM**

### 20MM SPACING Slotted gate side frame

4200MM LONG

Order Code: **AWXP-4200-GSF20**  
**XP-4200-GSF20-MN**

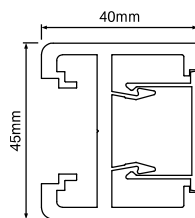

### TECH SPECS

- PP 170
- Alloy 6063-T5 / 4200mm long
- 3mm wall thickness with 3.8mm centre crossmember
- Slotted insert to suit 65x16.5mm slat with 20mm spacing
- Patented frame for friction insertion of slats
- Crossmember machined with drill holes along entire length to suit screw fixing of strategically placed 'gate slats' featuring screw flutes
- lxx = 6.294 x 10E3 mmE4
- lyy = 152.403 x 10E3 mmE4

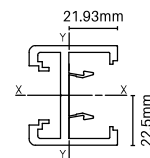

### Finishes



KWILA  
(KWI)



WESTERN  
RED CEDAR  
(WRC)



MONUMENT  
(MN)  
*For Island Grey*



### Snap-in gate insert

4200MM LONG

Order Code: **AWXP-4200-GI**  
**XP-4200-GI-MN**

**MATES WITH AWXP-4200-GSF09/20**  
**XP-4200-GSF09/20**

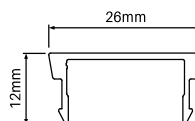

### TECH SPECS

- PP 100 / AP 100
- Alloy 6060-T5 / 4200mm long
- Snap-in gate insert mates with gate side frame
- Hides screws required for fixing 'gate slats' into position
- lxx = 0.86 x 10E3 mmE4
- lyy = 5.93 x 10E3 mmE4

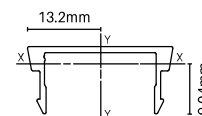

### Finishes



KWILA  
(KWI)



WESTERN  
RED CEDAR  
(WRC)



MONUMENT  
(MN)  
*For Island Grey*

# GATE EXTRUSIONS



## NON-PUNCHED Gate infill

4200MM LONG  
Order Code: **XP-XBAT-4200-INF**

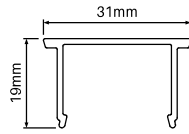

### Finishes



KWILA  
(KWI)



WESTERN  
RED CEDAR  
(WRC)



MONUMENT  
(MN)  
*For Island Grey*

## TECH SPECS

- PP 100 / AP 133
- Alloy 6060-T5 / 4200mm long
- Non-punched snap-in infill for gate side frames
- Required when making vertical gates, variable spaced horizontal slat gates or gates using 90mm x 16.5mm slats
- Replace existing slotted infill in gate side frame with non-punched gate infill
- bxx = 2.94 x 10E3 mmE4
- lyy = 9.50 x 10E3 mmE4

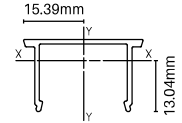

## Side frame

5800MM LONG  
Order Code: **AWQS-5800-SF**  
**QS-5800-SF-MN**

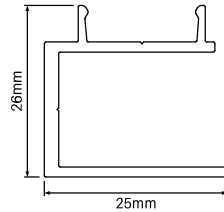

### Finishes



KWILA  
(KWI)



WESTERN  
RED CEDAR  
(WRC)



MONUMENT  
(MN)  
*For Island Grey*

## TECH SPECS

- PP 104 / AP 156
- Alloy 6063-T6 / 5800mm long
- Each slat must be screw fixed to frame
- Required for vertical slat gates, variable spaced horizontal gates or gates using 90x16.5mm slat
- Screw fixings are hidden when panel is assembled
- bxx = 9.58 x 10E3 mmE4
- lyy = 8.38 x 10E3 mmE4

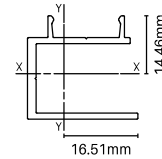

## Concealed fixing cover

5800MM LONG  
Order Code: **AWQS-5800-CFC**  
**QS-5800-CFC-MN**

**MATES WITH AWQS-5800-SF**  
**QS-5800-CFC**

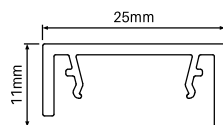

### Finishes



KWILA  
(KWI)



WESTERN  
RED CEDAR  
(WRC)



MONUMENT  
(MN)  
*For Island Grey*

## TECH SPECS

- PP 100 / AP 116
- Alloy 6060-T5 / 5800mm long
- Snap-on cover for Alumawood side frame
- Hides screws used to affix slats to side frame
- bxx = 0.71 x 10E3 mmE4
- lyy = 6.58 x 10E3 mmE4

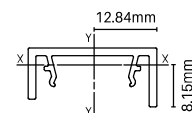

# GATE EXTRUSIONS



## Heavy duty top/bottom rail

5800MM OR 6100MM LONG

Order Code: **AWXP-5800-HD6545**  
**XP-6100-HD6545-MN**

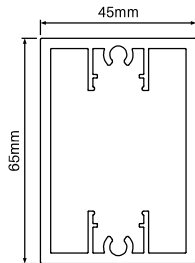

### Finishes



KWILA  
(KWI)



WESTERN  
RED CEDAR  
(WRC)



MONUMENT  
(MN)  
*For Island Grey*

## TECH SPECS

- PP 219 / AP 219
- Alloy 6063-T5 / 5800mm long for WRC & Kwila finish
- Alloy 6063-T5 / 6100mm long for Monument finish
- 3mm wall thickness
- Heavy duty top/bottom rail used for wide gates
- Also required for vertical slat gates, horizontal gates with variable spacing or gates fitted with a lockbox
- Non weld assembly using 12 gauge screws into screw flutes (Code: XP-SCREWSGF-10PK)
- lxx = 206.98 x 10E3 mmE4
- lyy = 427.32 x 10E3 mmE4

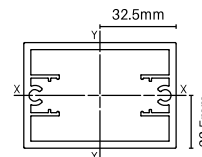

## Gate stop

4200MM LONG

Order Code: **AWXP-4200-GSTOP**  
**XP-4200-GSTOP-MN**

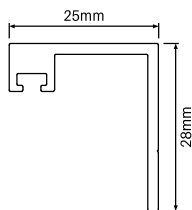

### Finishes



KWILA  
(KWI)



WESTERN  
RED CEDAR  
(WRC)



MONUMENT  
(MN)  
*For Island Grey*

## TECH SPECS

- PP 106 / AP 123
- Alloy 6063-T5 / 4200mm long
- Must be used on gates fitted with Lockwood 001 lockbox
- Bulb rubber sold separately (Code: XP-GATESTOP-RUB)
- lxx = 7.61 x 10E3 mmE4
- lyy = 10.95 x 10E3 mmE4

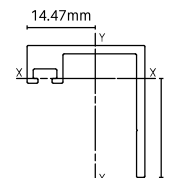

## Heavy duty U channel

5000MM LONG

Order Code: **AWQS-5000-HORIZ**  
**QS-5000-HORIZ-MN**

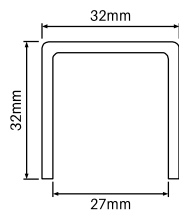

**FOR VERTICAL  
SLAT**

### Finishes



KWILA  
(KWI)



WESTERN  
RED CEDAR  
(WRC)



MONUMENT  
(MN)  
*For Island Grey*

## TECH SPECS

- PP 184 / AP 184
- Alloy 6060-T5
- 5000mm long
- Required for vertical slat pedestrian gates only. Use on both internal vertical sides to reduce light gaps at gate edges
- 2.5mm wall thickness
- lxx = 23.97 x 10E3 mmE4
- lyy = 38.92 x 10E3 mmE4

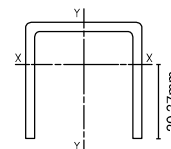

# GATE ACCESSORIES



## Deadlatch lockbox

ALUMINIUM

Terrain

Order Code: AW-LBOX-DL-TR

- Patented non-weld lockbox
- Terrain powdercoat matches well with Kwila & WRC
- Suits horizontal slat gates with 65x16.5mm slats
- Must use with gate side frame (AWXP-4200-GSF09/20)
- Screw fix assembly of pre-powder coated lockbox and extrusion
- Suits Lockwood 001 deadlatch (XP-DL001)



## Lever/knob lockbox

ALUMINIUM

Black, Monument or Woodland Grey

Order Code: XP-LBOX-LSET-B/MN/G

- Patented non-weld lockbox
- Powder coated black, monument or woodland grey
- Suits horizontal slat gates with 65x16.5mm slats
- Must use with gate kits (XP-GKIT-LSET09/20)
- Screw fix assembly of pre-powder coated lockbox and extrusion
- Suits knob or lever sets (Stanley or Lockwood models)



## Lockwood round knob set

HIGH PURITY ZINC ALLOY

Order Code: XP-HDL-LW534

- Lockwood model 534
- Knob set keyed both sides
- Lock / unlock both sides
- Suits left or right gate opening
- Satin Chrome brushed finish
- C4 5 pin on outside
- C4 6 pin restricted compatible on inside



## Lockwood 001 deadlatch

12Gx65MM HEX  
FLANGE HEAD

Order Code: XP-DL001

- Lockwood 001 deadlatch to suit metal frames
- Market leading performance & reliability
- Only suits inwards swinging gate
- Cut-resistant stainless steel bolt



## Stanley round knob set

STAINLESS STEEL

Order Code: XP-HDL-KNOB

- Knob set keyed both sides
- Lock / unlock both sides
- Suits left or right gate opening
- Stainless steel knob and rose
- C4 6 pin restricted compatible (Inside & outside)



## Stanley lever set

STAINLESS STEEL

Order Code: XP-HDL-LEVER

- Lever set keyed both sides
- Lock / unlock both sides
- Suits left or right gate opening
- Stainless steel knob and rose
- C4 6 pin restricted compatible (Inside & outside)

## Electric Striker

Order Code: XP-HDL-ES

- Optional electric striker kit
- Left or right handing
- Power required to lock/unlock
- 12 volt (DC current)
- LATCHING POST - face mount SS304 striker face plate with built in side keeper
- Requirement to notch latching post to recess electric striker mechanism
- Allow 9mm latching gap
- Compatible with locks: XP-HDL-LW534  
XP-HDL-KNOB



# GATE EXTRUSIONS

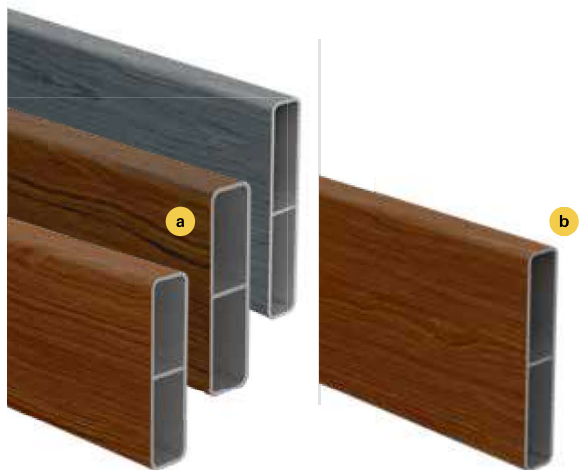

## SLAT OPTIONS —

For full slat specification, see page 103

- a** 65x16.5mm slat with centre web
- b** 90x16.5mm slat with centre web



### Sliding gate top rail

5800MM OR 6100MM LONG

Order Code: **AWSG-5800-TR**  
**XPSG-6100-TR-MN**

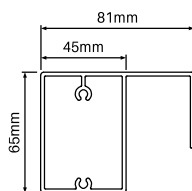

#### Finishes



KWILA  
(KWI)



WESTERN  
RED CEDAR  
(WRC)



MONUMENT  
(MN)  
*For Island Grey*

#### TECH SPECS

- PP 293 / AP 367
- Alloy 6063 T5 / 5800mm long for WRC & Kwila finish
- Alloy 6063 T5 / 6100mm long for Monument finish
- 2.5mm wall thickness
- Top rail with innovative side channel for slide guide or roller guide integration
- Screw flutes incorporated for non-weld assembly
- $l_x = 513.99 \times 10E3 \text{ mmE4}$
- $l_y = 404.97 \times 10E3 \text{ mmE4}$

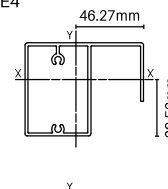

### Sliding gate bottom rail

5800MM OR 6100MM LONG

Order Code: **AWSG-5800-BR**  
**XPSG-6100-BR-MN**

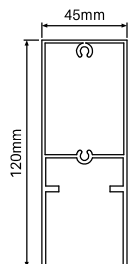

#### Finishes



KWILA  
(KWI)



WESTERN  
RED CEDAR  
(WRC)



MONUMENT  
(MN)  
*For Island Grey*

#### TECH SPECS

- PP 332 / AP 476
- Alloy 6063 T5 / 5800mm long for WRC & Kwila finish
- Alloy 6063 T5 / 6100mm long for Monument finish
- 1.8mm wall top section with 2.5mm wall thickness bottom legs
- Bottom rail with underside cavity for wheel recess fitting
- Screw flutes incorporated for non-weld assembly
- $l_x = 265.22 \times 10E3 \text{ mmE4}$
- $l_y = 994.41 \times 10E3 \text{ mmE4}$

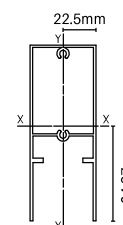



# GATE EXTRUSIONS



**PATENTED FRICTION FIT SYSTEM**

## 9MM SPACING Slotted gate side frame

4200MM LONG

Order Code: **AWXP-4200-GSF09**  
**XP-4200-GSF09-MN**

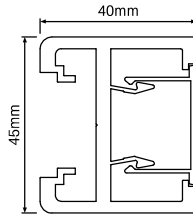

### Finishes



KWILA  
(KWI)



WESTERN  
RED CEDAR  
(WRC)



MONUMENT  
(MN)  
*For Island Grey*

### TECH SPECS

- PP 170
- Alloy 6063-T5 / 4200mm long
- 3mm wall thickness with 3.8mm centre crossmember
- Slotted insert to suit 65x16.5mm slat with 9mm spacing
- Patented frame for friction insertion of slats
- Crossmember machined with drill holes along entire length to suit screw fixing of top & bottom rail as well as centrally located 'gate' slat
- $l_{xx} = 6.294 \times 10E3 \text{ mmE4}$
- $l_{yy} = 152.403 \times 10E3 \text{ mmE4}$

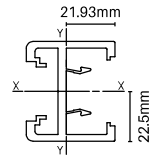

**PATENTED FRICTION FIT SYSTEM**

## 20MM SPACING Slotted gate side frame

4200MM LONG

Order Code: **AWXP-4200-GSF20**  
**XP-4200-GSF20-MN**

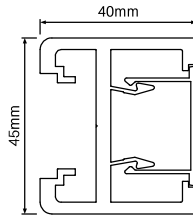

### Finishes



KWILA  
(KWI)



WESTERN  
RED CEDAR  
(WRC)



MONUMENT  
(MN)  
*For Island Grey*

### TECH SPECS

- PP 170
- Alloy 6063-T5 / 4200mm long
- 3mm wall thickness with 3.8mm centre crossmember
- Slotted insert to suit 65x16.5mm slat with 20mm spacing
- Patented frame for friction insertion of slats
- Crossmember machined with drill holes along entire length to suit screw fixing of top & bottom rail as well as centrally located 'gate' slat
- $l_{xx} = 6.294 \times 10E3 \text{ mmE4}$
- $l_{yy} = 152.403 \times 10E3 \text{ mmE4}$

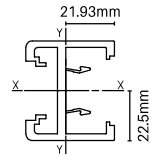

## Snap-in gate insert

4200MM LONG

Order Code: **AWXP-4200-GI**  
**XP-4200-GI-MN**

**MATES WITH AWXP-4200-GSF09/20**  
**XP-4200-GSF09/20**

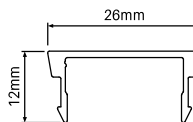

### Finishes



KWILA  
(KWI)



WESTERN  
RED CEDAR  
(WRC)



MONUMENT  
(MN)  
*For Island Grey*

### TECH SPECS

- PP 100 / AP 100
- Alloy 6060-T5 / 4200mm long
- Snap-in gate insert mates with gate side frame
- Hides screws required for fixing of top & bottom rail and 'gate' slats
- $l_{xx} = 0.86 \times 10E3 \text{ mmE4}$
- $l_{yy} = 5.93 \times 10E3 \text{ mmE4}$

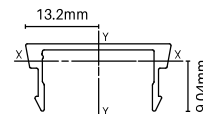

# GATE EXTRUSIONS



## NON-PUNCHED Gate infill

4200MM LONG

Order Code: **AWXP-XBAT-4200-INF**  
**XP-XBAT-4200-INF-MN**

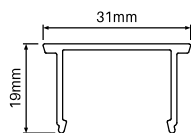

### Finishes



KWILA  
(KWI)



WESTERN  
RED CEDAR  
(WRC)



MONUMENT  
(MN)  
*For Island Grey*

## TECH SPECS

- PP 100 / AP 133
- Alloy 6060-T5 / 4200mm long
- Non-punched snap-in infill for gate side frames
- Required when making vertical slat sliding gates, variable spaced horizontal slat gates or gates using 90mm x 16.5mm slats
- Replace existing slotted infill in gate side frame with non-punched gate infill if required
- bxx = 2.94 x 10E3 mmE4
- lyy = 9.50 x 10E3 mmE4

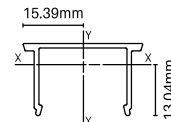

## Side frame

5800MM LONG

Order Code: **AWQS-5800-SF**  
**QS-5800-SF-MN**

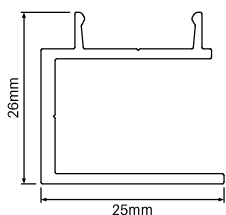

### Finishes



KWILA  
(KWI)



WESTERN  
RED CEDAR  
(WRC)



MONUMENT  
(MN)  
*For Island Grey*

## TECH SPECS

- PP 104 / AP 156
- Alloy 6063-T6 / 5800mm long
- Used for sliding gates with horizontal variable slat spacing and also vertical slat sliding gates
- Each slat must be screw fixed to side frame
- Affix side frame to 45mm x 40mm gate frame
- bxx = 9.58 x 10E3 mmE4
- lyy = 8.38 x 10E3 mmE4

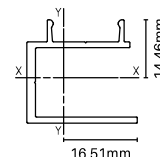

## Concealed fixing cover

5800MM LONG

Order Code: **AWQS-5800-CFC**  
**QS-5800-CFC-MN**

**MATES WITH AWQS-5800-SF**  
**QS-5800-SF**

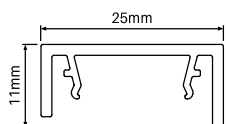

### Finishes



KWILA  
(KWI)



WESTERN  
RED CEDAR  
(WRC)



MONUMENT  
(MN)  
*For Island Grey*

## TECH SPECS

- PP 100 / AP 116
- Alloy 6060-T5 / 5800mm long
- Snap-on cover for Alumawood side frame
- Hides screws used to affix slats to side frame
- bxx = 0.71 x 10E3 mmE4
- lyy = 6.58 x 10E3 mmE4

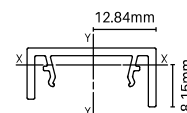

# GATE EXTRUSIONS



## Heavy duty U channel

5000MM LONG

Order Code: **AWQS-5000-HORIZ**  
**QS-5000-HORIZ-MN**

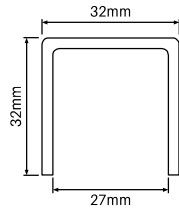

**FOR VERTICAL SLAT**

### Finishes



KWILA  
(KWI)



WESTERN  
RED CEDAR  
(WRC)



MONUMENT  
(MN)  
*For Island Grey*

## TECH SPECS

- PP 184 / AP 184
- Alloy 6060-T5
- 5000mm long
- Required for vertical slat sliding gates only. Use on both internal vertical sides to reduce light gaps at gate edges
- 2.5mm wall thickness
- lxx = 23.97 x 10E3 mmE4
- lyy = 38.92 x 10E3 mmE4

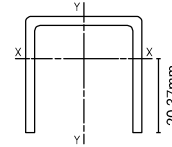

## 65mm x 16.5mm gate slat with centre web & 2x screw flutes

5800MM LONG

Order Code: **AW-5800-GB65**  
**XP-6100-GB65-MN**

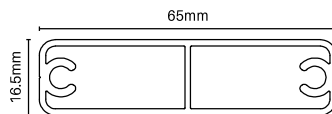

### Finishes



KWILA  
(KWI)



WESTERN  
RED CEDAR  
(WRC)



ISLAND GREY  
(IG)

## TECH SPECS

- PP 158 / AP 158
- Alloy 6063-T6
- 5800mm long
- 1.5mm wall thickness with 1.2mm wall centre web
- 2x screw flutes
- Interpon base coat: Italian image film
- Used in strategic positions for horizontal sliding gate assembly
- Non weld assembly using 12 gauge screws into screw flutes (Code: XP-SCREWSGF-10PK)
- lxx = 11.85 x 10E3 mmE4
- lyy = 144.09 x 10E3 mmE4

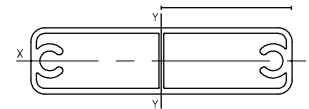

## Centre support rail

5800MM LONG

Order Code: **AWXP-5800-CSR**  
**XP-5800-CSR-MN**

### OPTIONAL EXTRA

Snap-on cover hides fixings – provides slimline sturdy support rail with no visible fixings

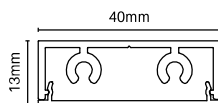

### Finishes



KWILA  
(KWI)



WESTERN  
RED CEDAR  
(WRC)



MONUMENT  
(MN)  
*For Island Grey*

## TECH SPECS

- PP 126 / AP 188
- Alloy 6063-T5
- 5800mm long
- Screwing fix centre support rail provides support to slats used in horizontal sliding gates
- For extra rigidity, centre support rail is braced to the top & bottom rail
- lxx = 1.73 x 10E3 mmE4
- lyy = 26.34 x 10E3 mmE4

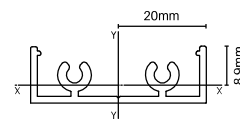

# GATE EXTRUSIONS

## 65x65mm steel post

2700MM LONG

Order Code: XPSG-2700-ST65-B

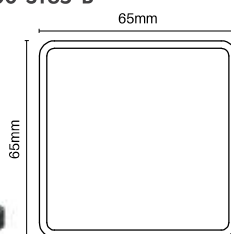

BLACK  
(B)



MONUMENT  
(MN)  
*For Island Grey*

### TECH SPECS

- 65x65mm galvanised steel post
- Includes press in black cap
- 2.5mm wall thickness
- Use at gate end to affix guide rollers or slide guide
- May also be used at gate front for affixing U or F catch
- Includes welded on 8mm thick base plate with 2 x 12.8mm diam fixing holes - use for base plated post fixing or bury into concrete for superior anchoring

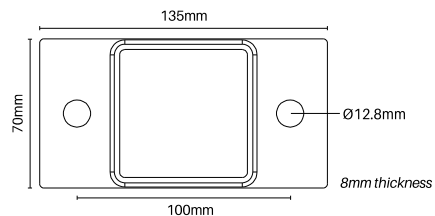

## Sliding gate extension

400MM LONG

Order Code: AWSG-MXTN-KIT  
XPSG-MXTN-KIT-MN

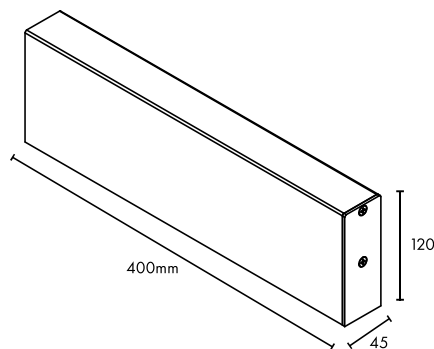

### TECH SPECS

- 400mm long bottom rail extension
- Optional extra - useful where extra length required for motor rack to be affixed to bottom rail.
- Not required for every slide gate install. Recommended only where install situation requires
- Extension piece fixes to gate side frame
- Fixing bolts and plates included in kit
- Bottom rail is timber imaged with terrain powder coat end plate

#### Finishes



KWILA  
(KWI)



WESTERN  
RED CEDAR  
(WRC)



MONUMENT  
(MN)  
*For Island Grey*

Simply bolt onto bottom of gate side frame during assembly process

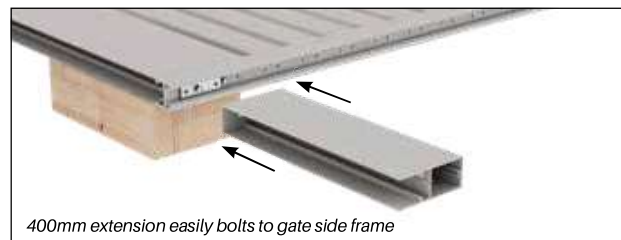

400mm extension easily bolts to gate side frame

